

**The following document is not readable via Optical Character Recognition. For more information or if you require the document to be read aloud please call: 304-399-5353**

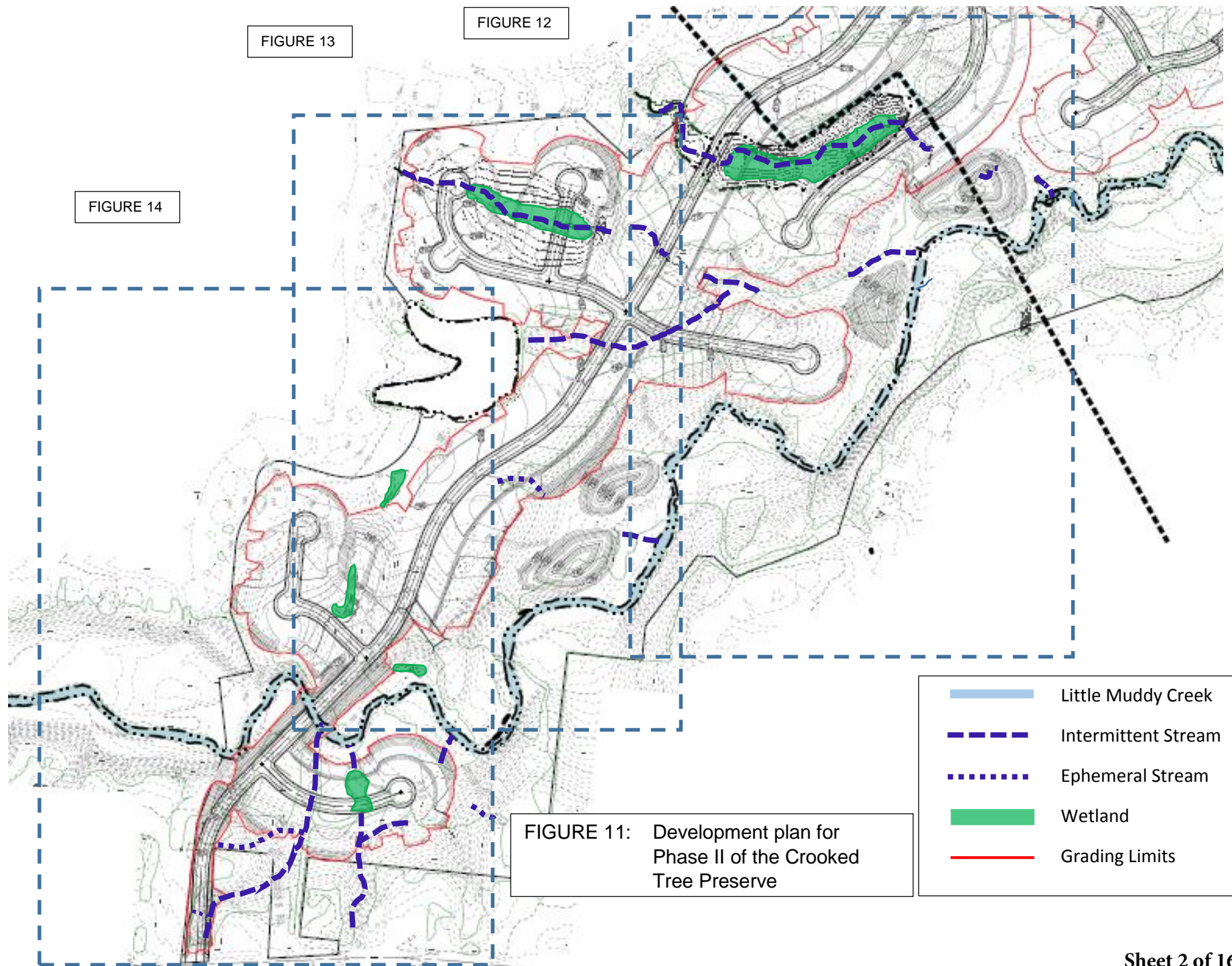







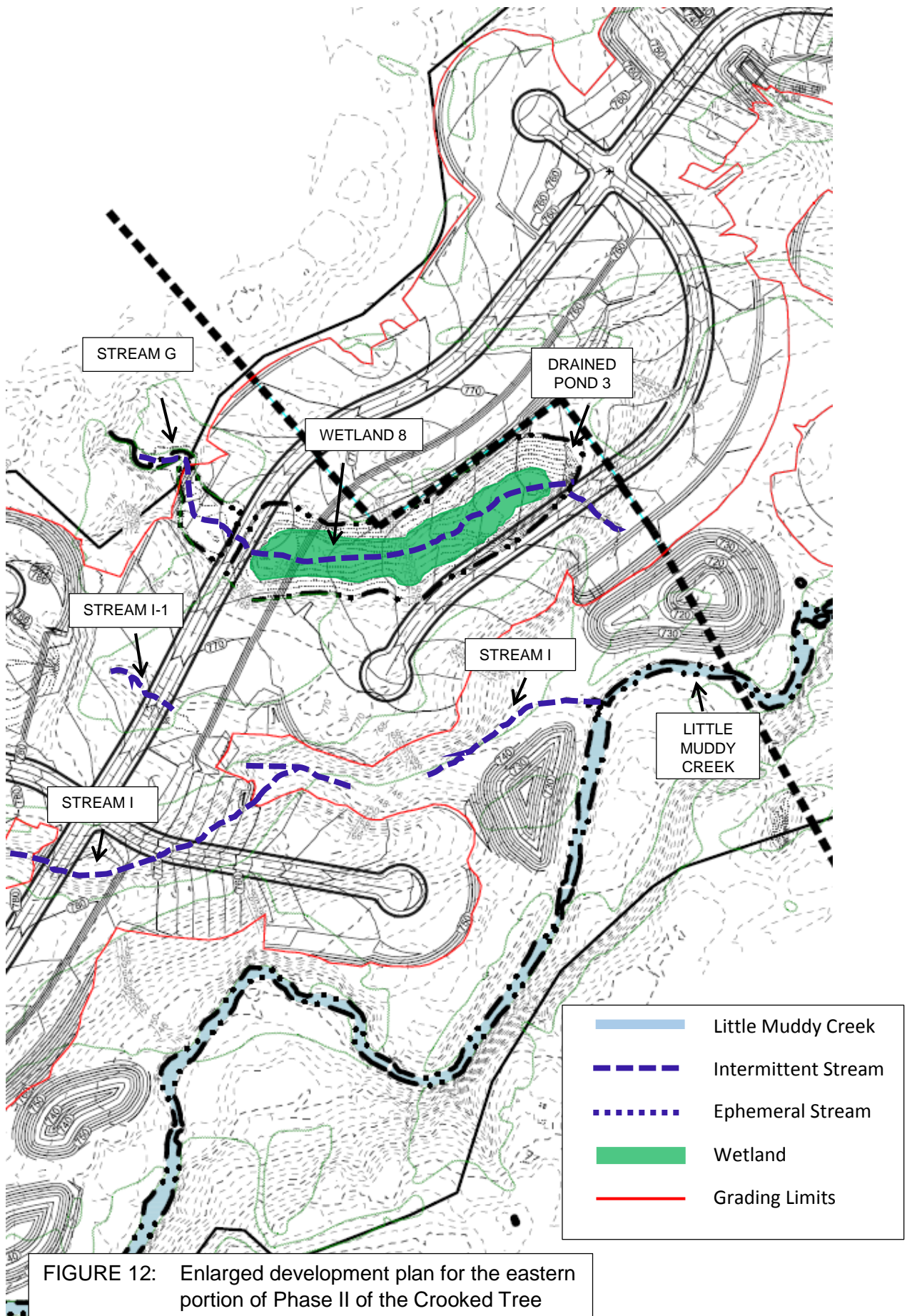

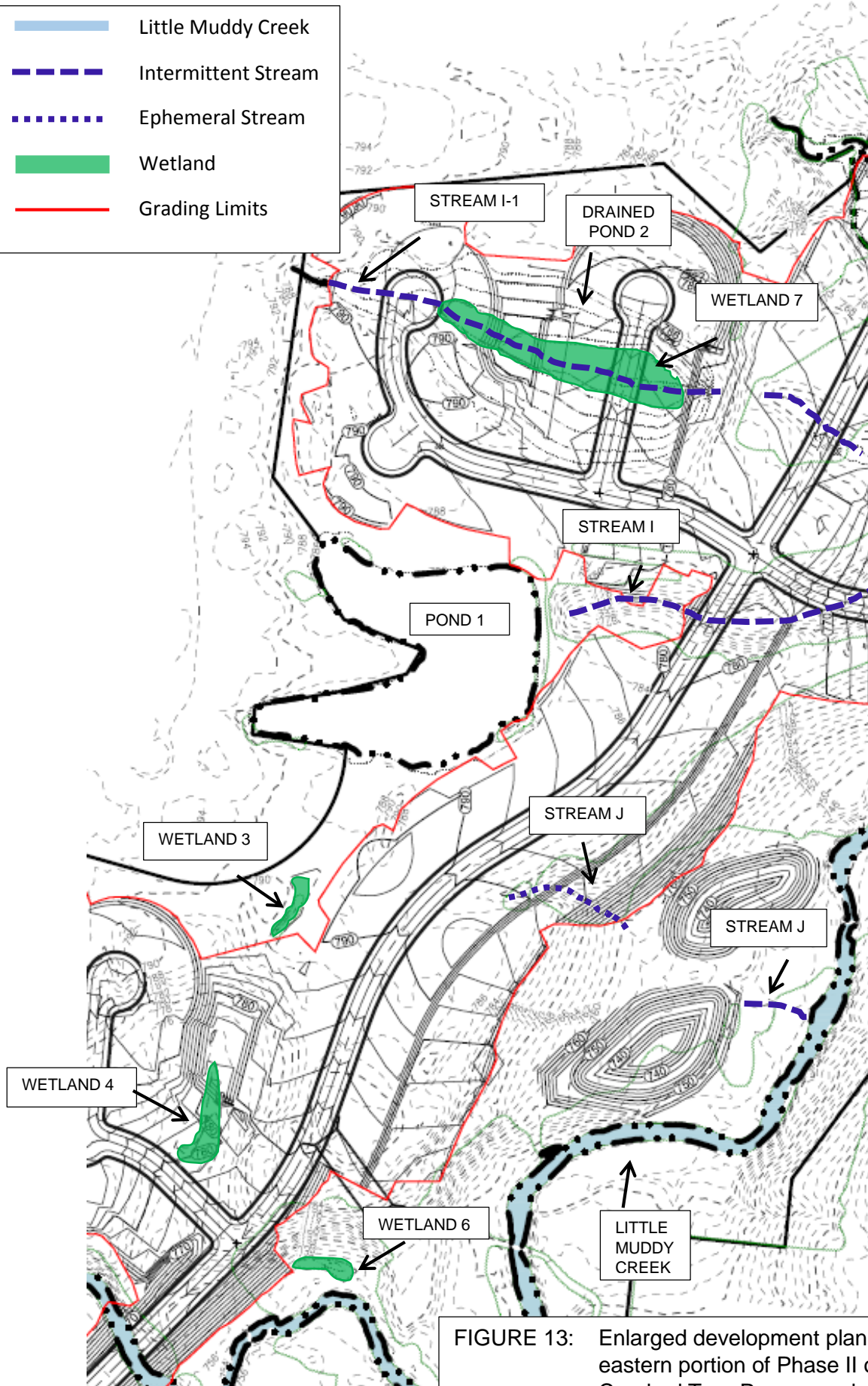
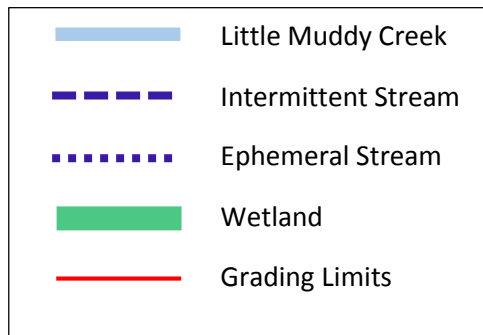

FIGURE 13: Enlarged development plan for the eastern portion of Phase II of the Crooked Tree Preserve, showing impacts to on-site streams and wetlands.



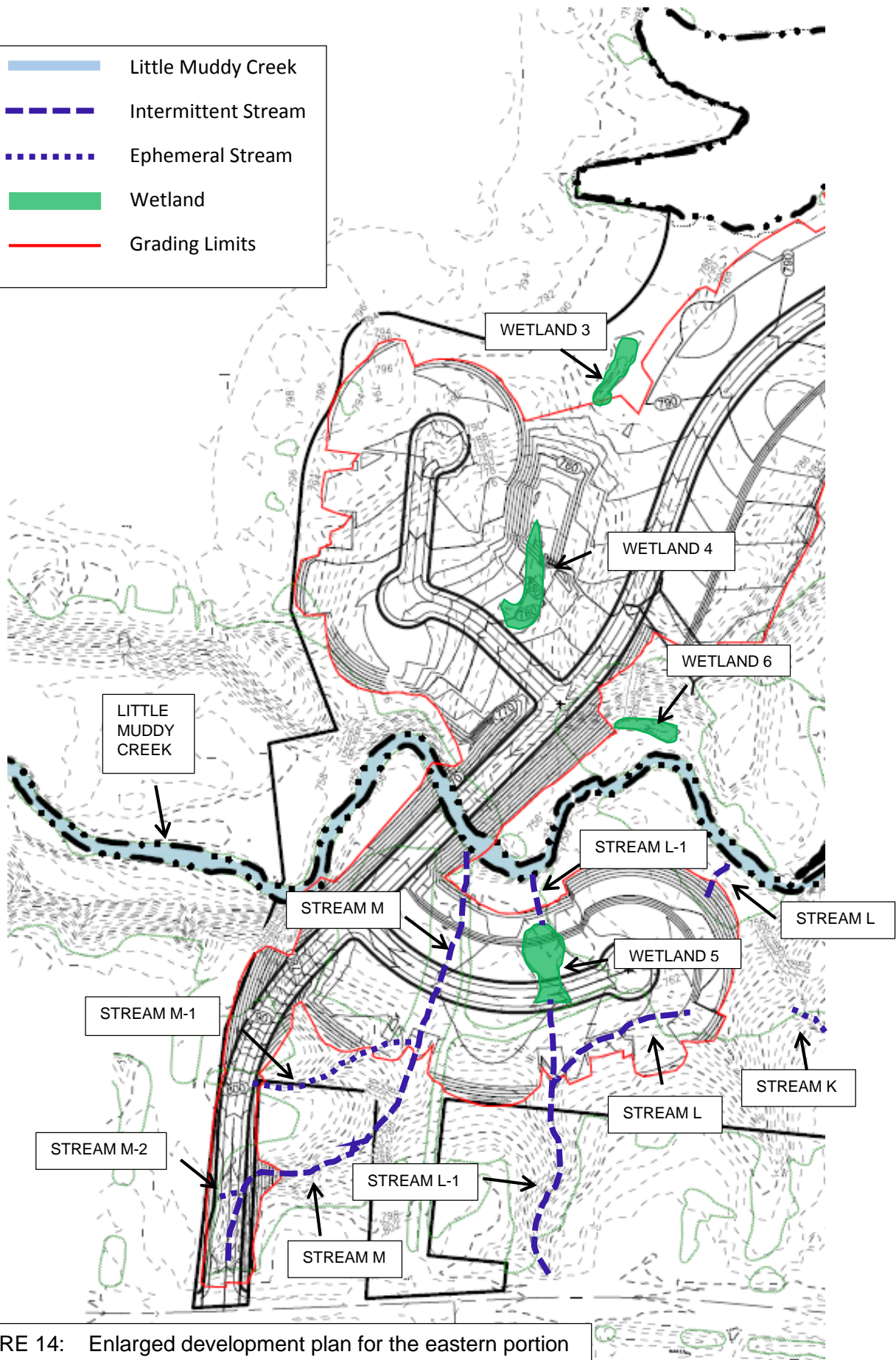
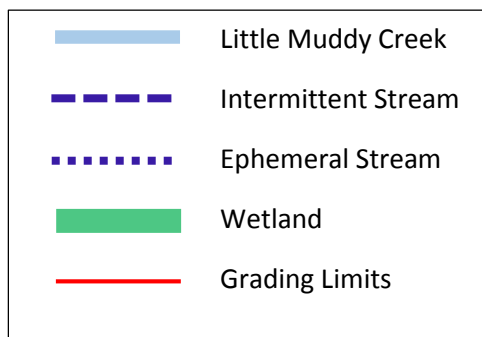

FIGURE 14: Enlarged development plan for the eastern portion of Phase II of the Crooked Tree Preserve, showing impacts to on-site streams and wetlands.

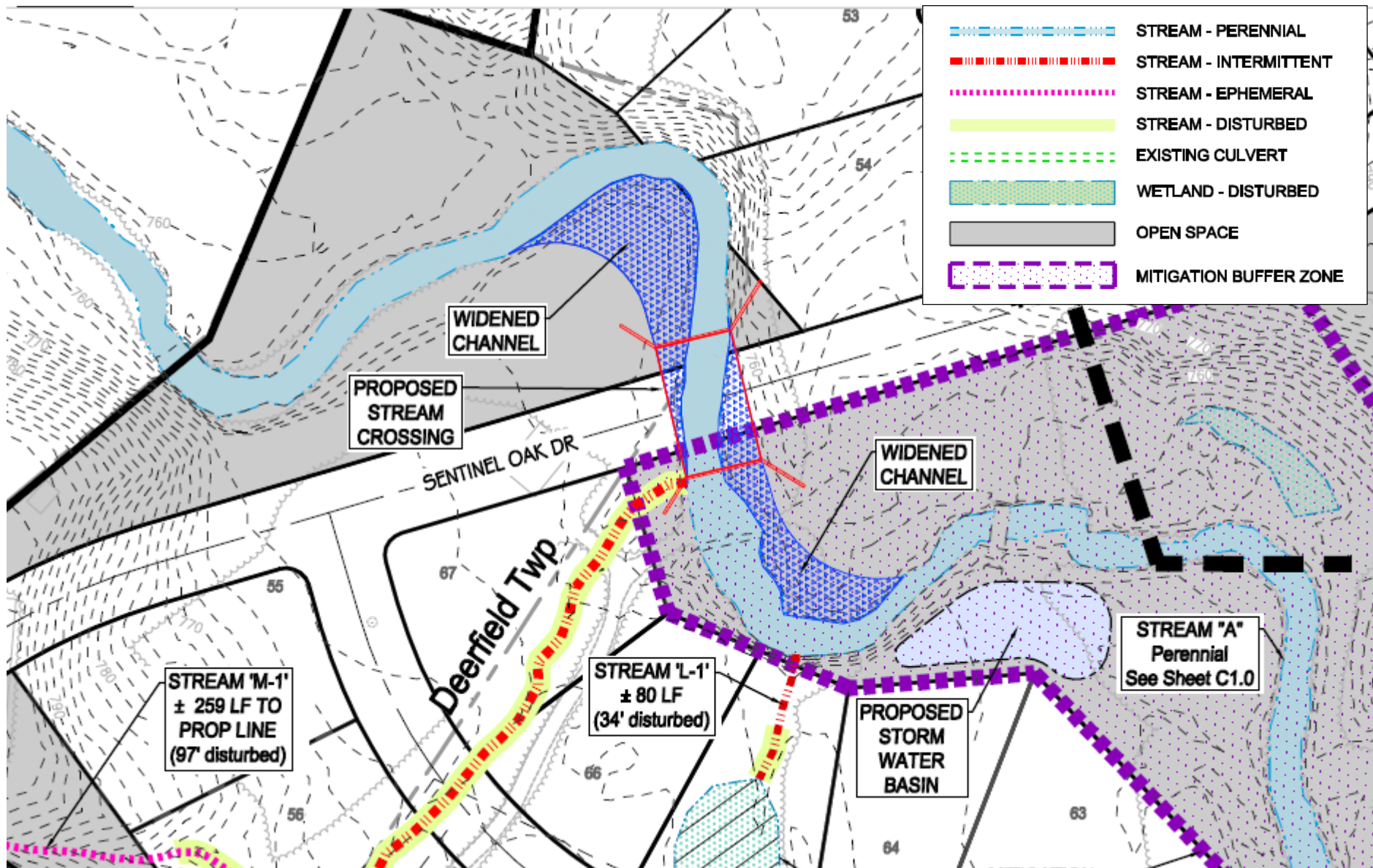

FIGURE 15: Design plan for the Little Muddy Creek road crossing, and surrounding area, in the southern portion of the Crooked Tree Phase II Property. The Little Muddy Creek stream channel will be extensively widened in the area surrounding the road crossing, so slow flow velocity in this area and help prevent future damage to the crossing structure. This channel widening will also alleviate erosion along the outside of channel bends on either side of the crossing.

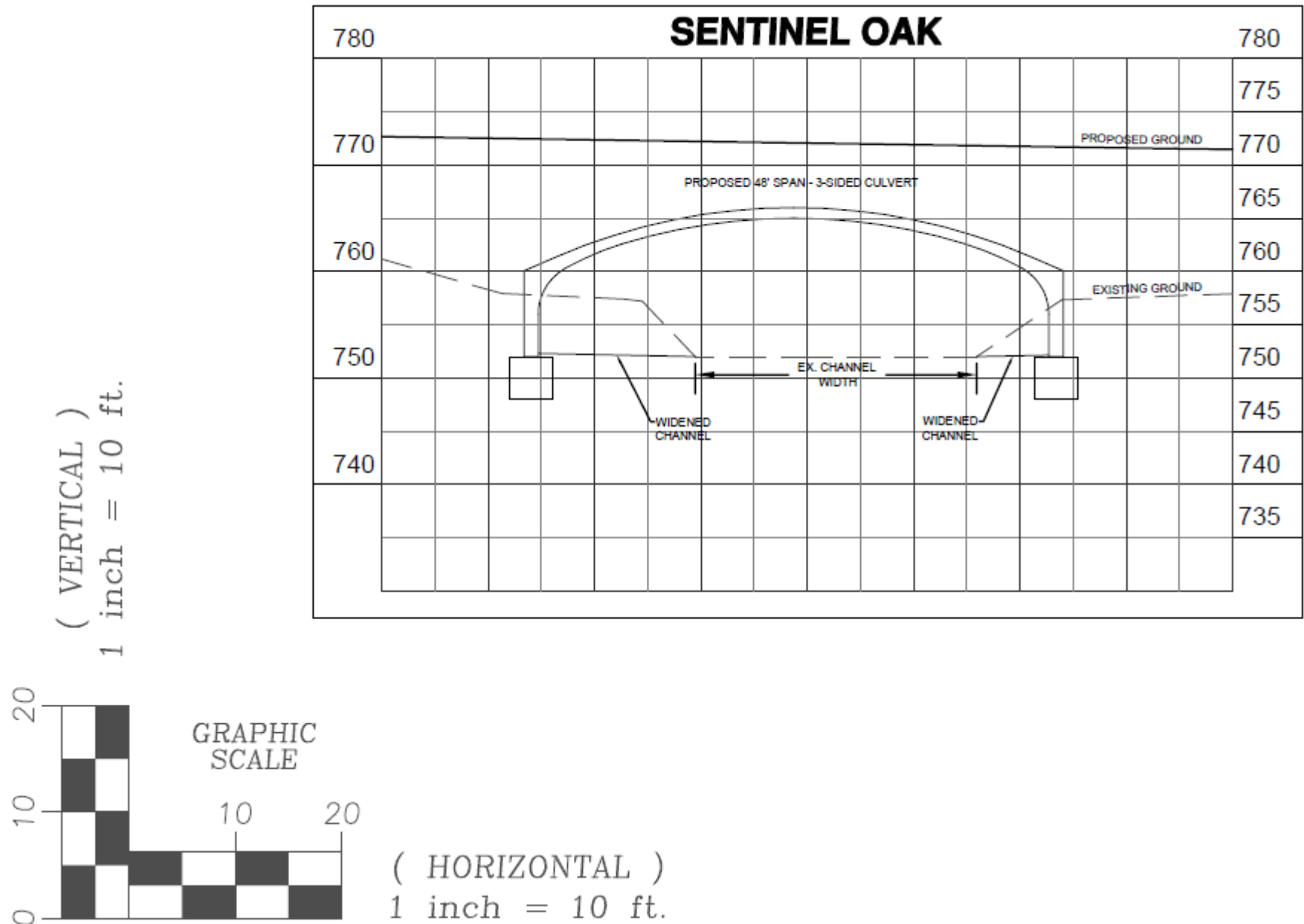

FIGURE 16: Cross-sectional design plan for the Sentinel Oak road crossing over Little Muddy Creek in the southern portion of the Crooked Tree Preserve. This bottomless crossing structure will be 48 ft wide, and will span the width of the Little Muddy Creek channel. The remaining area under the crossing will be cut down to the elevation of the stream bed and will become part of the Little Muddy Creek channel.



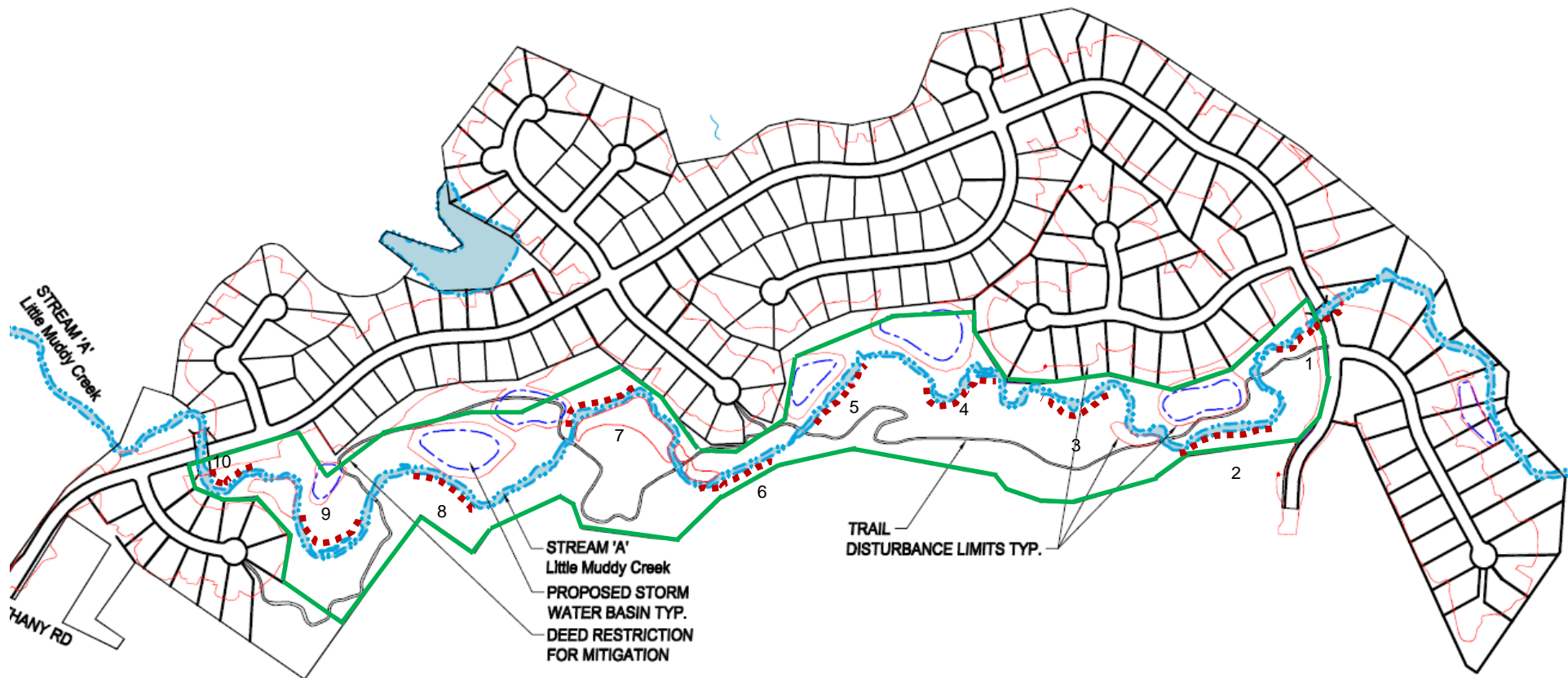

FIGURE 17: Map of the Crooked Tree Preserve, showing the boundaries of the buffer zone which will be placed under an environmental covenant (solid green line), and the ten monitoring locations along Little Muddy Creek (dotted red line). These ten sections of Little Muddy Creek will be evaluated using the U.S. Environmental Protection Agency's (USEPA) Rapid Bioassessment Protocols (RBP) for Use in Streams and Wadeable Rivers (most current edition), and the Ohio EPA's Headwater Habitat Evaluation Index (HHEI). In addition, the biology at Locations 2, 4, 8, and 9 will be evaluated using the Ohio EPA's Headwater Macroinvertebrate Field Evaluation Index (HMFEl)

FIGURE 18: Location reference for Figures 19-25

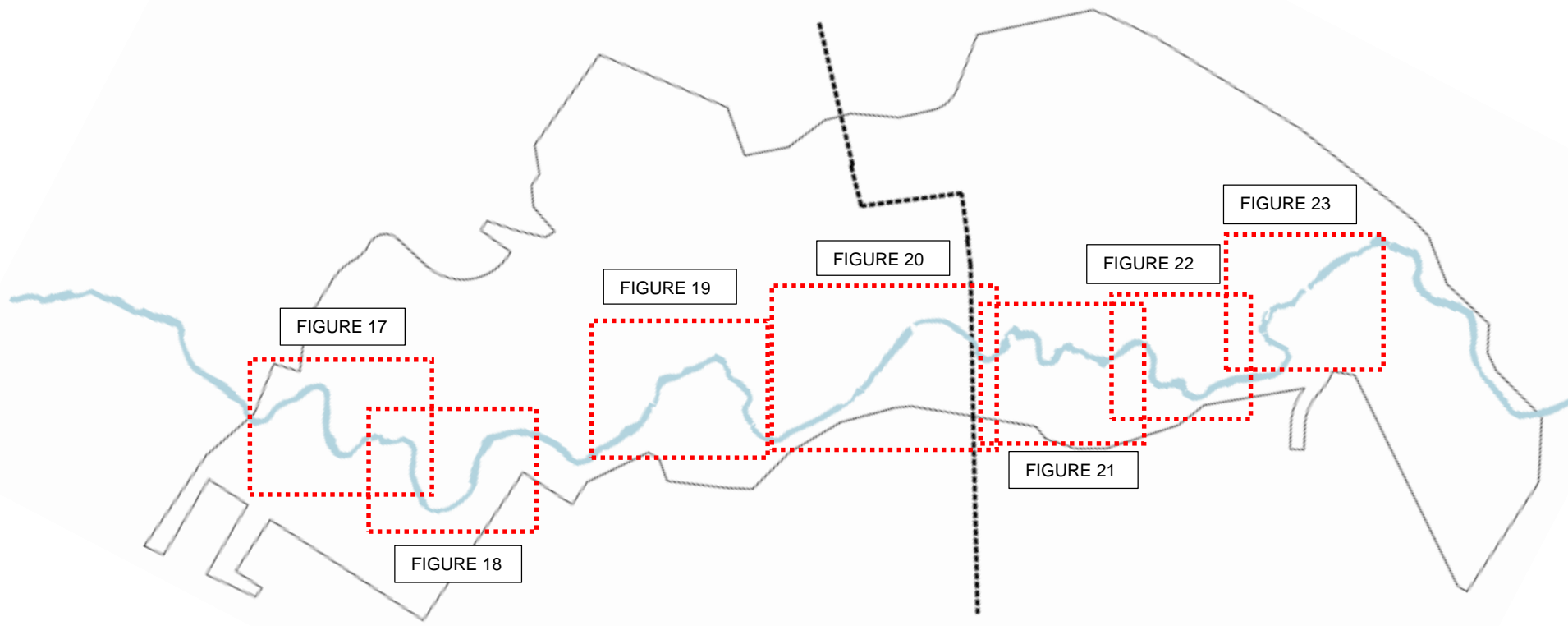
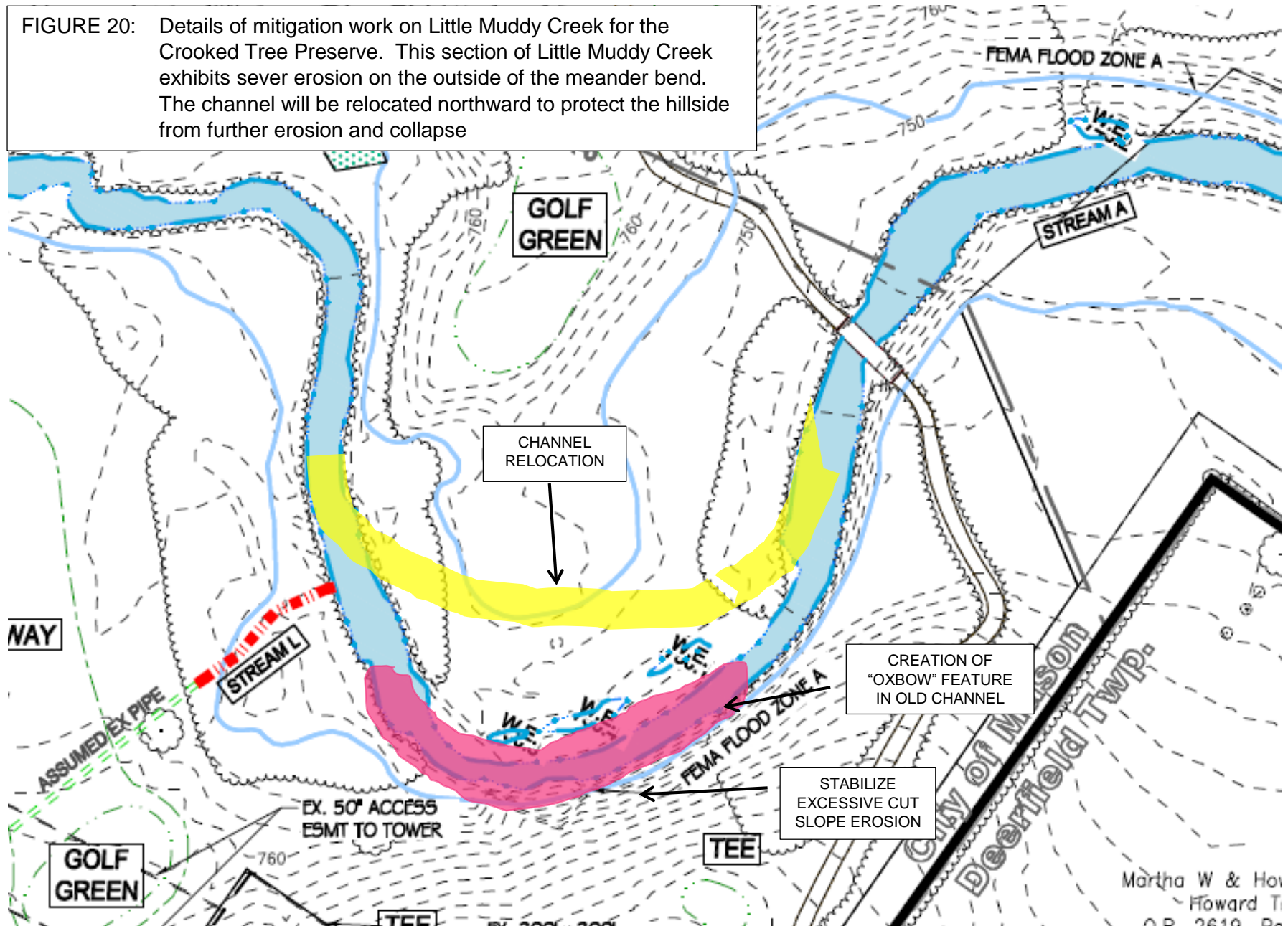





FIGURE 20: Details of mitigation work on Little Muddy Creek for the Crooked Tree Preserve. This section of Little Muddy Creek exhibits sever erosion on the outside of the meander bend. The channel will be relocated northward to protect the hillside from further erosion and collapse





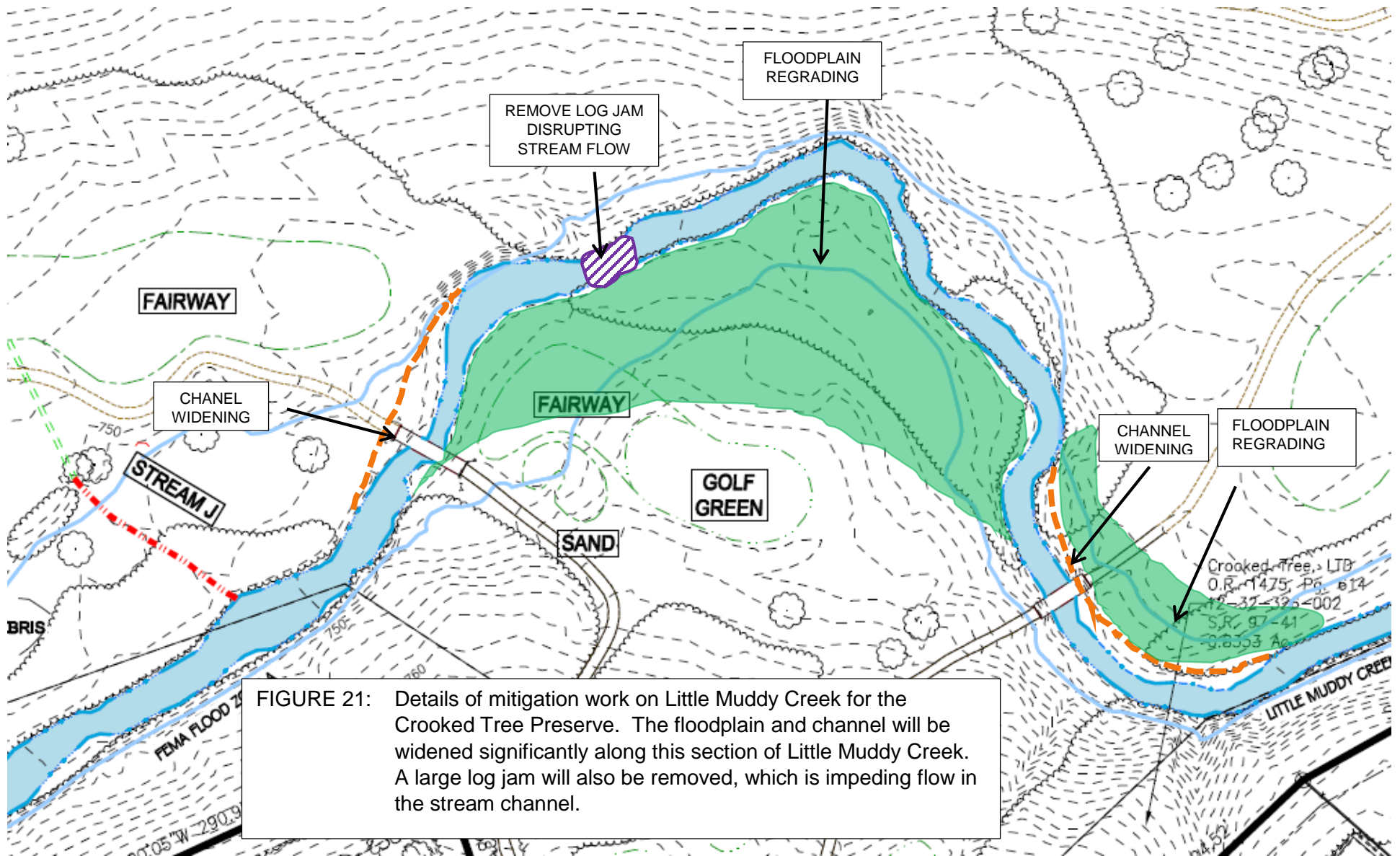
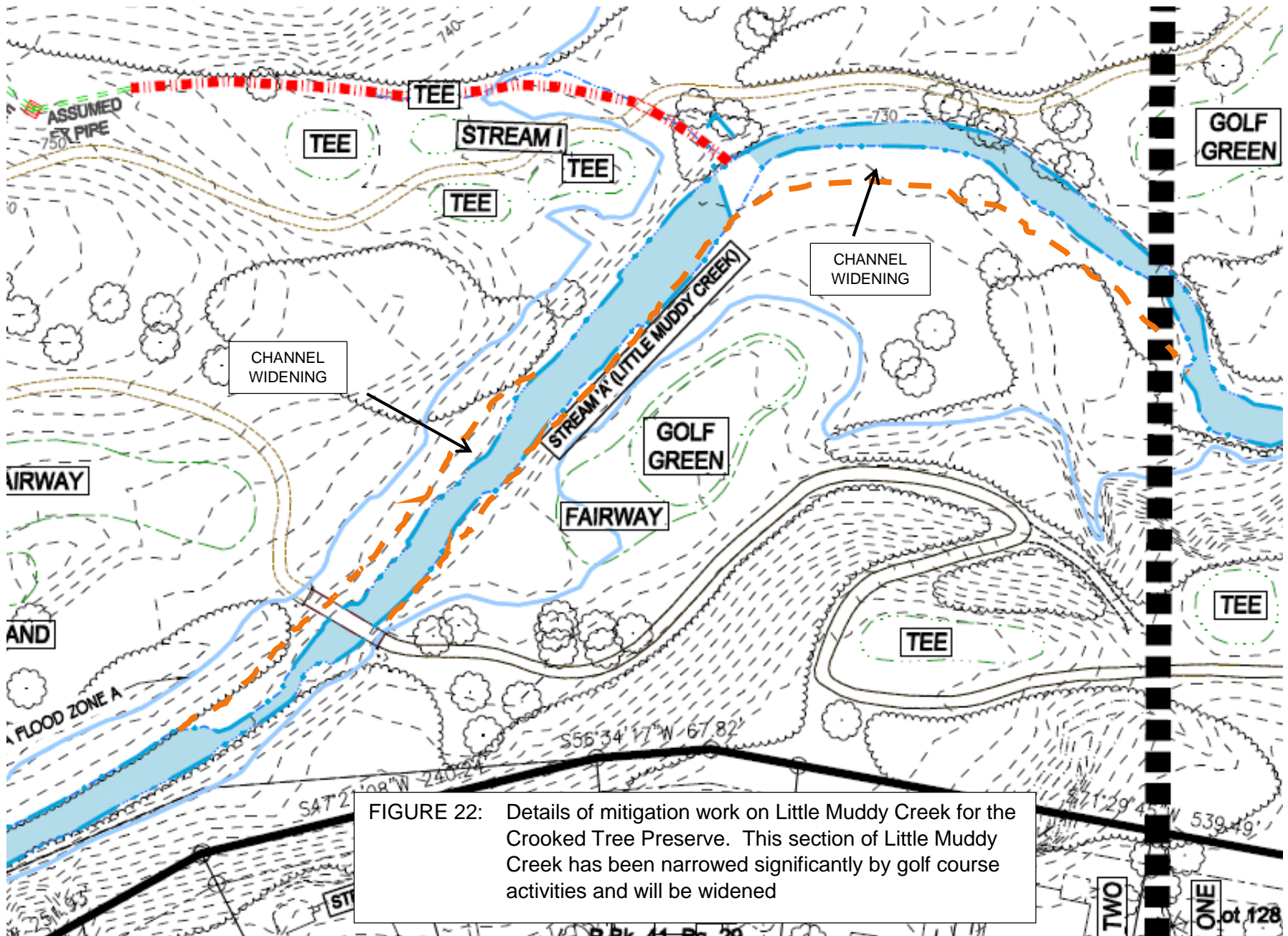
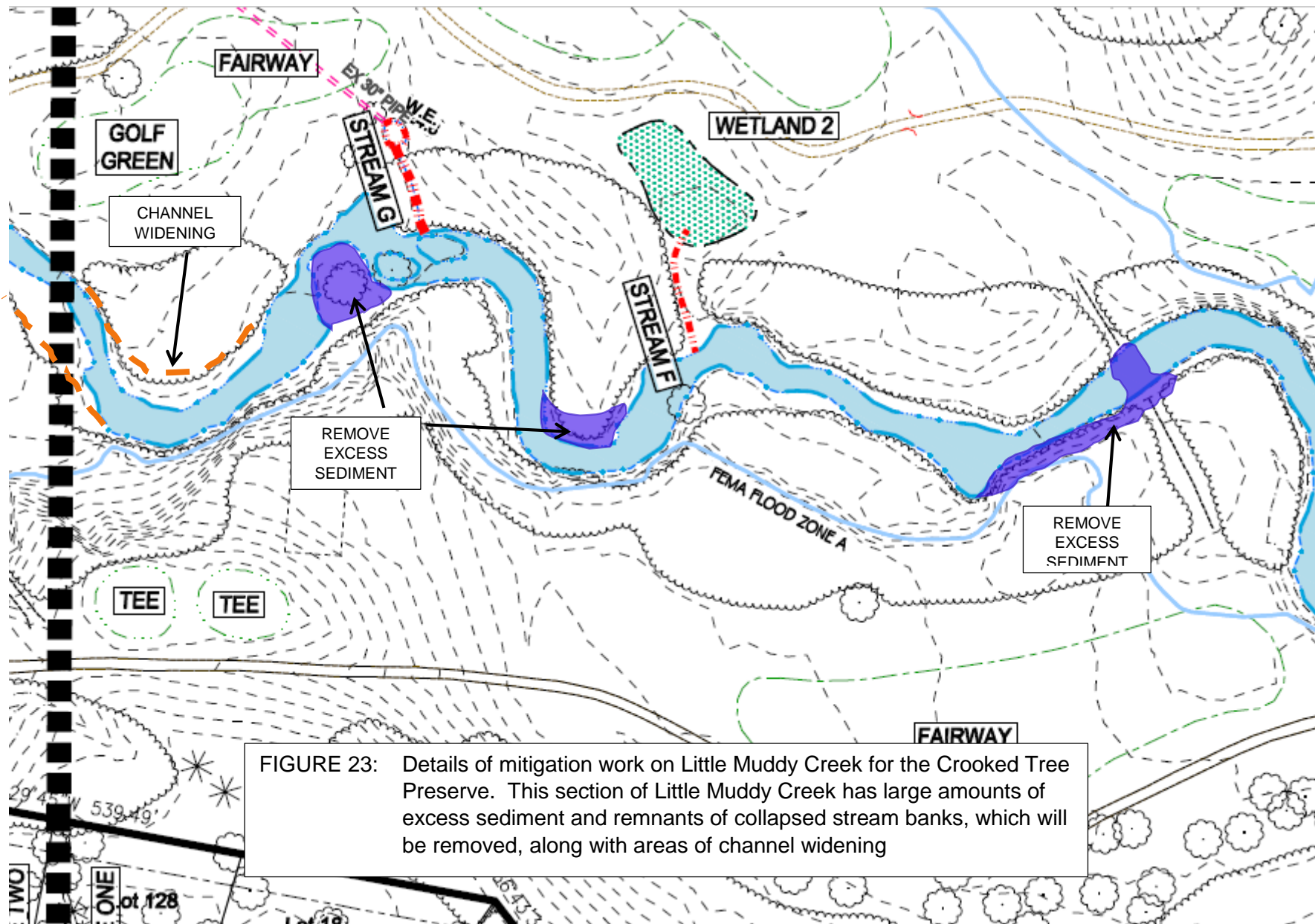

FIGURE 21: Details of mitigation work on Little Muddy Creek for the Crooked Tree Preserve. The floodplain and channel will be widened significantly along this section of Little Muddy Creek. A large log jam will also be removed, which is impeding flow in the stream channel.







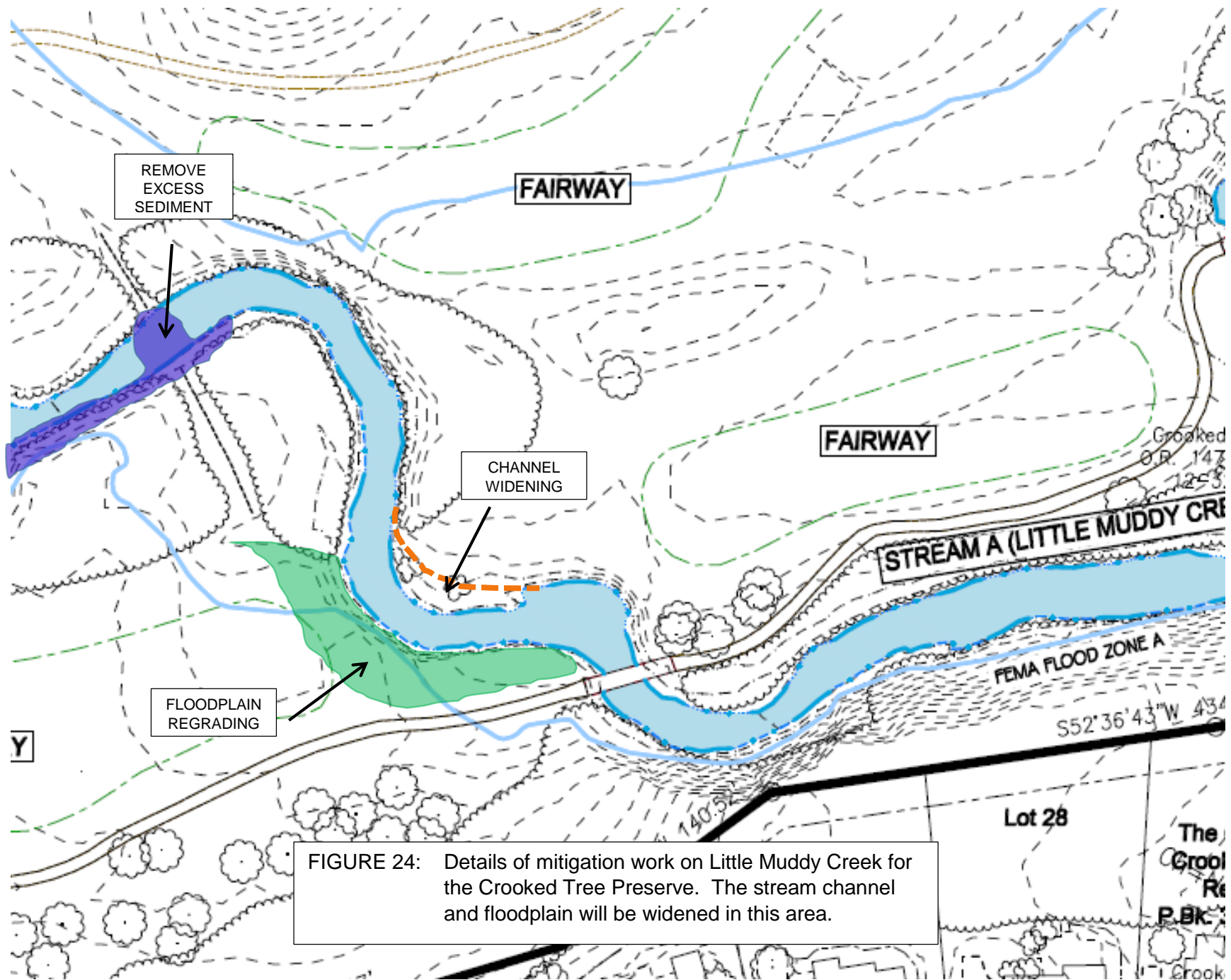

FIGURE 24: Details of mitigation work on Little Muddy Creek for the Crooked Tree Preserve. The stream channel and floodplain will be widened in this area.



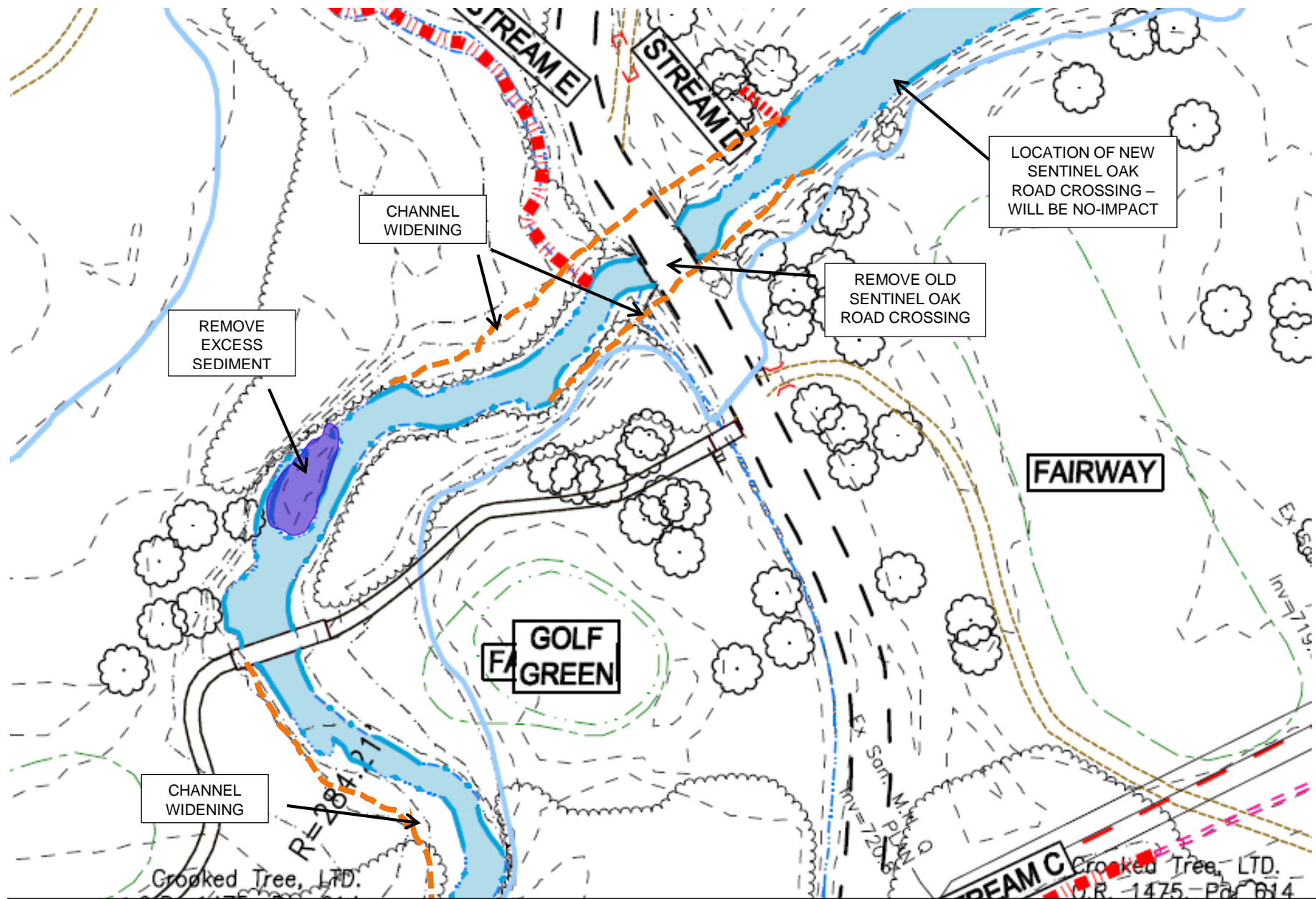

FIGURE 25: Details of mitigation work on Little Muddy Creek for the Crooked Tree Preserve. The stream channel will be widened and sediment will be removed from the channel in this area. In addition, the old Sentinel Oak road crossing over Little Muddy Creek, which has impeded stream flow and caused areas of excessive erosion, will be removed.

Please note that the new Sentinel Oak Crossing will also be located in this area. This crossing will be a no-impact crossing.